

## Installing Unsigned Drivers on Windows8

To install uncertified drivers on Windows 8 it is necessary to reboot the computer, with "Driver Signature Enforcement" Disabled. This is a similar idea to safe mode on earlier versions of windows.

1) Click on "Restart" while holding down the Shift key

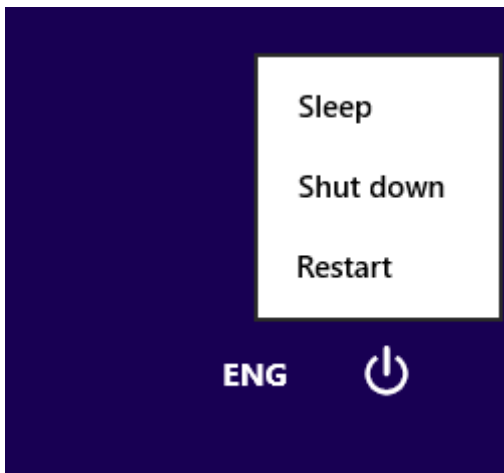

Windows will start to shutdown and you will be given the options below;

2) Click on "Troubleshoot".

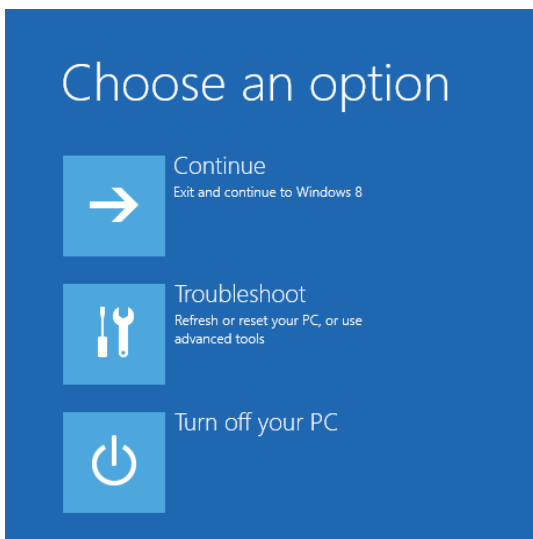

3) Click on "Advanced Options".

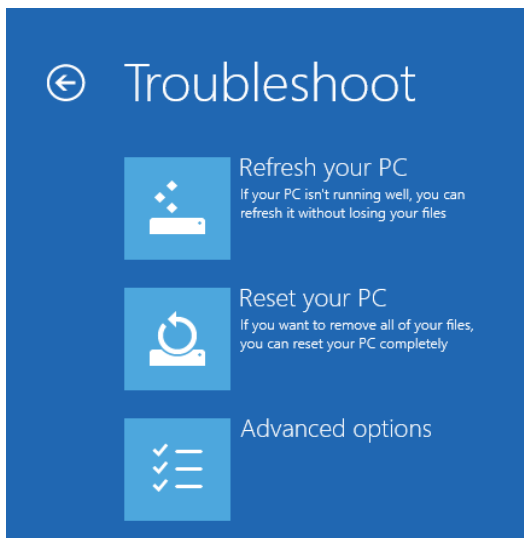

4) Click on "Startup Settings"

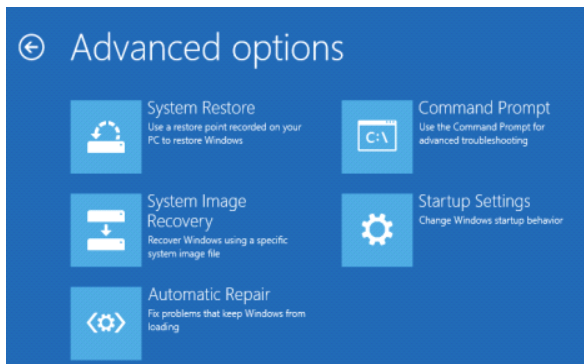

5) Click on "Restart"

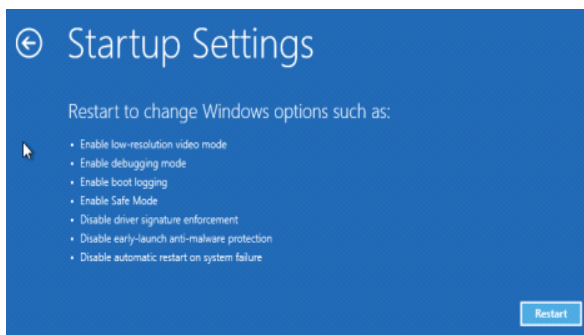

6) The PC will now reboot, halting at the Safe mode options screen.

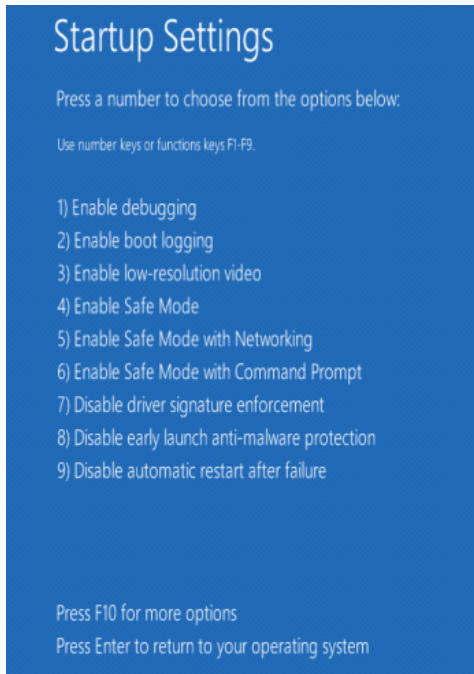

Press the 7 key on your keyboard, to continue booting with Driver signature enforcement disabled.

Unsigned drivers can now be installed, by clicking past the usual warnings.